

# For Lease 260 AIRPORT INDUSTRIAL DR

YPSILANTI, MICHIGAN

8,000 sf with 1,350 sf office

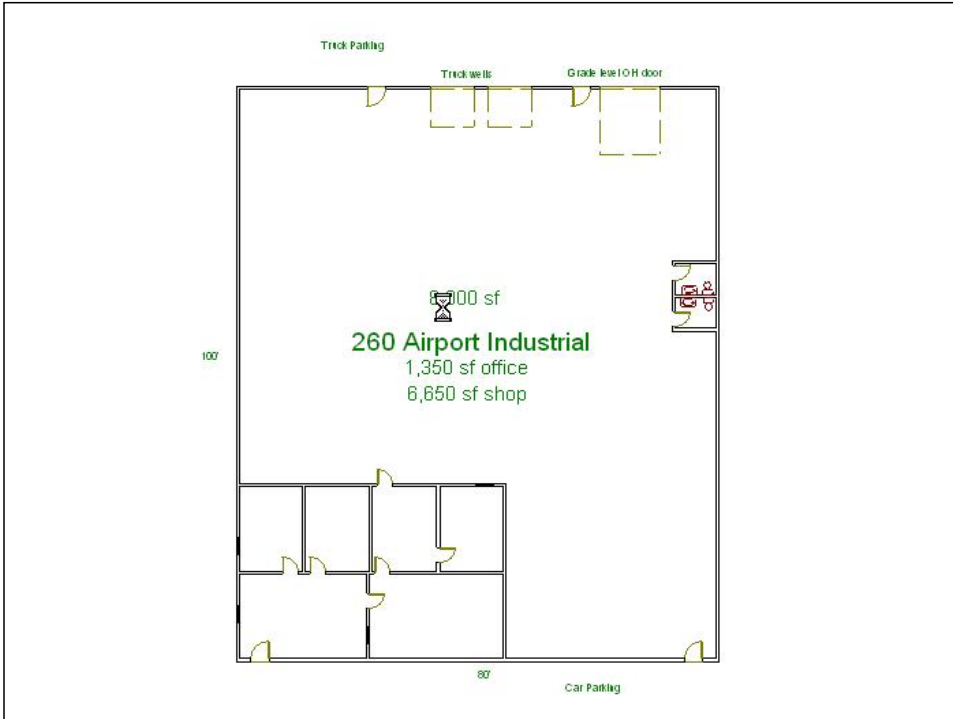

**LOCATION:** Part of Airport Industrial Center, a multi-tenant industrial park with 272,000 sf in 11 buildings on 37 acres. Located off the M-17/US-12 bypass northwest of Willow Run Airport in Ypsilanti Township, Washtenaw County.

**BUILDING:** 260 Airport Industrial Drive is a 8,000 sf space with 1,350 sf of office which includes 1 restroom, 1 truck well, 2 grade level overhead doors, 16+ ceilings, and is fully sprinklered.

**ZONING:** I-2 General Industrial, Ypsilanti Township, 734-483-3943

**UTILITIES:** Gas and electric from DTE (800-477-4747), water and sewer from YCUA (734-484-4600), electrical service is 200 amps of 208 volt 3 phase.

**ACCESS TO EXPRESSWAYS:** Airport Industrial Drive has direct access to I-94 within 1 mile, 6 miles west of US-23, or 8 miles east of I-275.

**WEBSITE:** [www.airportindustrialcenter.com](http://www.airportindustrialcenter.com)

**LEASE RATE:** \$3.75 per sf Net. Tax, Insurance, and CAM is \$1.50/sf. Total monthly rent is \$3,500.

Contact: **David Hamilton, CCIM**

direct: 734-662-3745

[daveh@swishercommercial.com](mailto:daveh@swishercommercial.com)

Building relationships.



208 East Washington St. Ann Arbor, MI 48104  
tel: 734.663.0501 fax: 734.663.0316  
[www.swishercommercial.com](http://www.swishercommercial.com)